

Push-Pull Slide Gate

Series "E"

For Gravity Flow Applications and Vacuum



Available in sizes 2" to 12"

Standard Features

- Stainless steel material contact points.
 - Dust tight seals.
- Lightweight aluminium frame, corrosion resistant.
 - Rated for 82°C (180°F).

We deliver what we promise on time every time!

Push Pull Slide Gate

Stud Bolt Flanged

Bolt Thru Pipe Flange Connection

Qty. (I) 5/16 NC studs on a (J) DBC

Qty. (K) 1/2" Ø holes on a (L) DBC

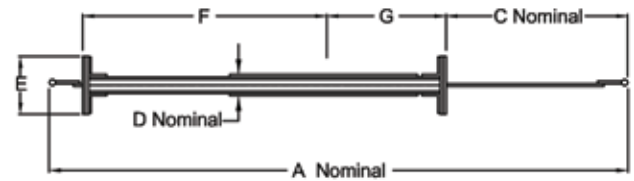
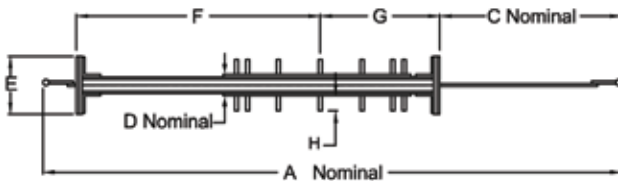
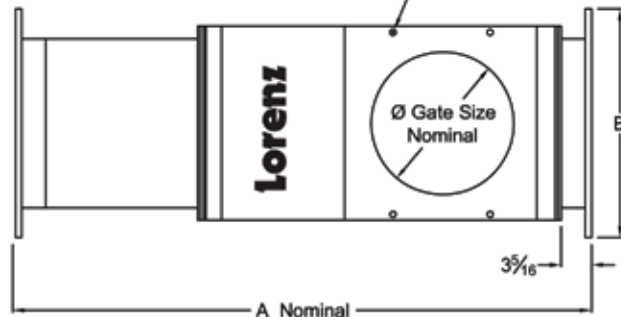
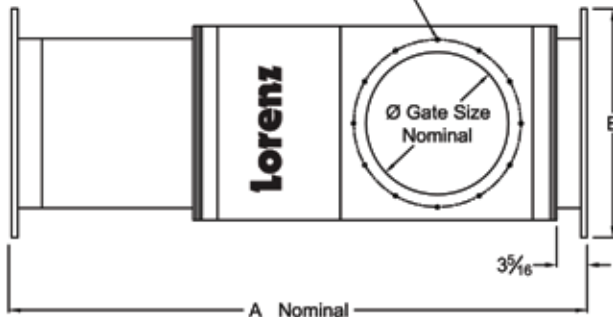

Gate Size	A	B	C	D	E	F	G	H	I	J	K	L
2"	16 1/4	8 5/8	5	1 3/4	4 3/8	4 7/8	3 7/8	1 1/8	4	3 7/8	2	4 3/4
3"	19 3/8	10 1/8	6	1 3/4	4 3/8	6 1/4	4 1/2	1 1/8	4	5	2	6
4"	22 1/2	11 1/8	7	1 3/4	4 3/8	8	5	1 1/8	6	5 1/2	4	7 1/2
5"	27 1/8	12 1/8	8	1 3/4	4 3/8	10 5/8	6	1 1/8	8	6 1/2	4	8 1/2
6"	29 1/4	12 7/8	8 1/2	1 3/4	4 3/8	11 1/8	7	1 1/8	8	7 1/2	4	9 1/2
8"	35 5/8	14 7/8	11	1 3/4	4 3/8	14 1/8	8	1 1/8	8	9 1/2	4	11 3/4
10"	41 3/4	16 7/8	13	1 3/4	4 3/8	17 1/4	8 7/8	1 1/4	8	11 1/2	4	14 1/4
12"	47 5/8	18 7/8	15	1 7/8	4 3/8	20 1/8	9 7/8	1 1/4	12	13 13/16	4	17

Options.

• 316 stainless material contact.

• High temperature service.

We deliver what we promise on time every time!